



QUALI`METAL System

for Manufacturing, Trading & Contracting Aluminum



www.quali-metal.com

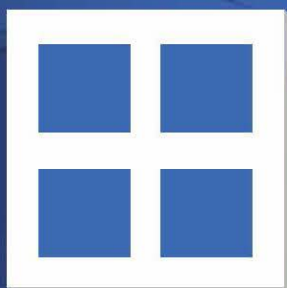

QUALI`METAL System
for Manufacturing, Trading & Contracting Aluminum

CONTENT INDEX

Pages

4	<i>About Us</i>
6	<i>Products</i>
18	<i>Services</i>
20	<i>Guarantee</i>
21	<i>Certificate</i>
22	<i>Credintitials</i>
40	<i>Factory</i>
42	<i>Parteners</i>



Our metal fabrication plant is equipped with computerized saws & various machining centers, CNC controlled sheet metal working machines and conveyor assembly. This plant is equipped to offer you not only Architectural opening solution, but also highest international standard such as all façade working curtain wall, structural glazing, windows and doors and many other products which fall under the definition of architectural metal works such as louvers, Balustrades, metal cladding, skylights, we can offer all these products in Aluminum depending on our technical office of expert engineering for design, analysis and technical support.

ABOUT

Quali'metal was founded on 1994 in Cairo – Egypt as a small workshop for Aluminum fabricators.

We develop a new factory in the industrial area in Obour City, 20 Km. from Cairo on 2003 with 5 million investment holding on the same name Quali'metal system also we have finished a Show room with administration department in Sheraton Heliopolis area located in Cairo.

We are one of the first leading companies in Egypt started IT System (Software) for metal equipment.

MISSION

We provide our factory with the latest high technology machines depending on research and development that meets international advanced level of quality for exporting.

Our planet is developing another bigger factory under construction to meet the market needs for more producing adding another production line and CNC cladding lines

TODAY

We are equipped for producing about 3000 m² / month of aluminum opening, our ideal production; we will reach up to 6000 m² /month with our new factory. We are planning to develop another two sections with the same quality control for cladding composite panels and double glass line coat to insure our whole product quality.

Today our company manufacture license includes import and export. That is meeting our needs from accessories and machines for the production lines.

GOALS

To be one of the biggest companies in Egypt and Africa in field of Aluminum manufacturing & trading



Doors & Windows

We produce all shapes for architectural opening windows and doors to match all designs which proceed by the consultant and match the design purpose such as sliding, hinged, folding, tilt turn and tilt slide window or doors

J 100

The J – 100 (Jumbo) been designed to respond for aesthetics and security indicate heavy weight sliding of frame 51/80 mm with sash 86 mm and glass thickness up to 26 mm available with net sliding extruded rail (110 mm / 51 mm) two or three rail could be assembly up to six leaf

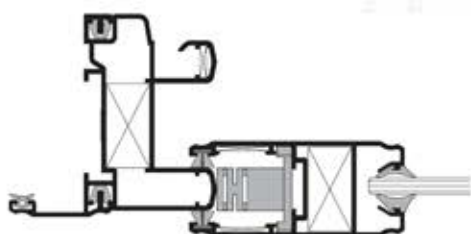

*Technical Charactarestic

Frame	Depth	74mm -to- 134mm
	Height	53mm -to- 106mm
Sash	Depth	36mm
	Height	86mm
Max glass thickness	Up to 24mm	
Max sash weight	Up to 170kg	
Sealing type	Perimetrical, with two rows of high-density brushes.	

*Complies with the European norm hEN 14351-1

Air permability	(Class 3) up to 600 pa
Water tightness	(Class 8A) up to 450 pa
Resistance to wind load	(Class B2) up to 800 pa





TG 60

The TG60- (Tango) also two or three rail indicating sliding system of medium weight of frame 46/54 mm with sash 67 mm and glass thickness up to 20 mm also available with extruded frame for sliding net (46/86.5 mm).

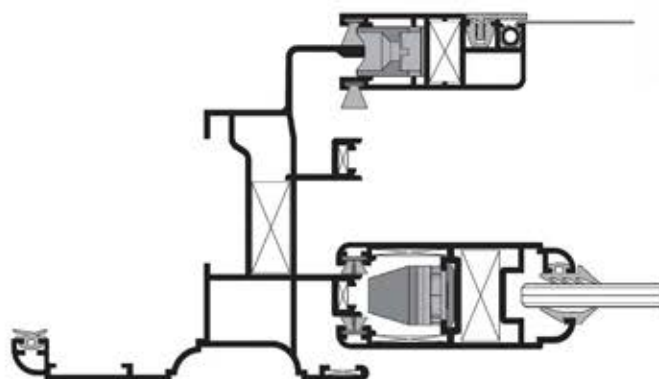

*Technical Characteristic

Frame	Depth	48mm -to- 148mm
	Height	46mm -to- 100mm
Sash	Depth	28mm
	Height	67mm
Max glass thickness	Up to 18mm	
Max sash weight	Up to 90kg	
Sealing type	Perimetrical, with two rows of high-density brushes.	

*Complies with the European norm hEN 14351-1

Air permeability	(Class 3) up to 600 pa
Water tightness	(Class 5A) up to 200 pa
Resistance to wind load	(Class C4) up to 1600 pa



RC 60

The new RC60- (Rock) an extensive range of non-insulated hinged system profiles for the construction of elegant and moderately priced aluminum frame 51/61 mm with visual or hidden vent 56 mm in functional style. Therefore is the ideal system for out-door applications in warm climates but it can also be used for the partitioning of indoor office spaces. We could use glass up to 32mm thickness.

The system is available in inward opening windows and inward and outward opening flush doors.

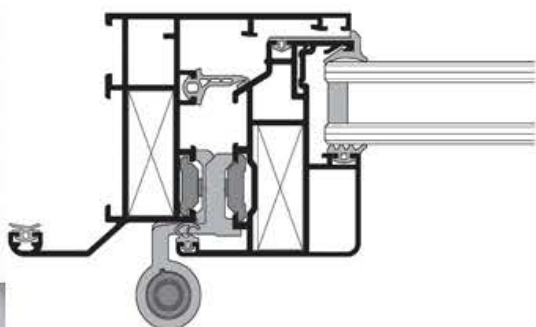
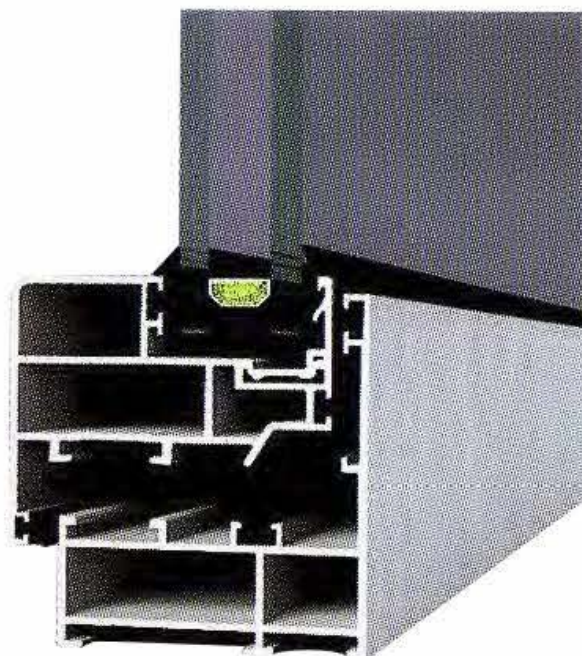

*Technical Characteristic

Frame	Depth	61mm - to 74mm
	Height	62mm - to 130mm
Sash	Depth	39mm - to 71mm
	Height	57mm - to 87mm
Max glass thickness	Up to 44mm	
Max sash weight	Up to 180kg	
Sealing type	EPDM gasket with Central gasket	

*Complies with the European norm hEN 14351-1

Air permeability	(Class 4) up to 600 pa
Water tightness	(Class E900) up to 900 pa
Resistance to wind load	(Class C4) up to 1600 pa

TN 120

The new TN120- (Tendu) been designed to respond for aesthetics and security indicate very heavy weight sliding system of frame 50/104 mm with sash 86 mm and glass thickness up to 26 mm available with net sliding extruded rail (124 mm / 50 mm) two rail could be

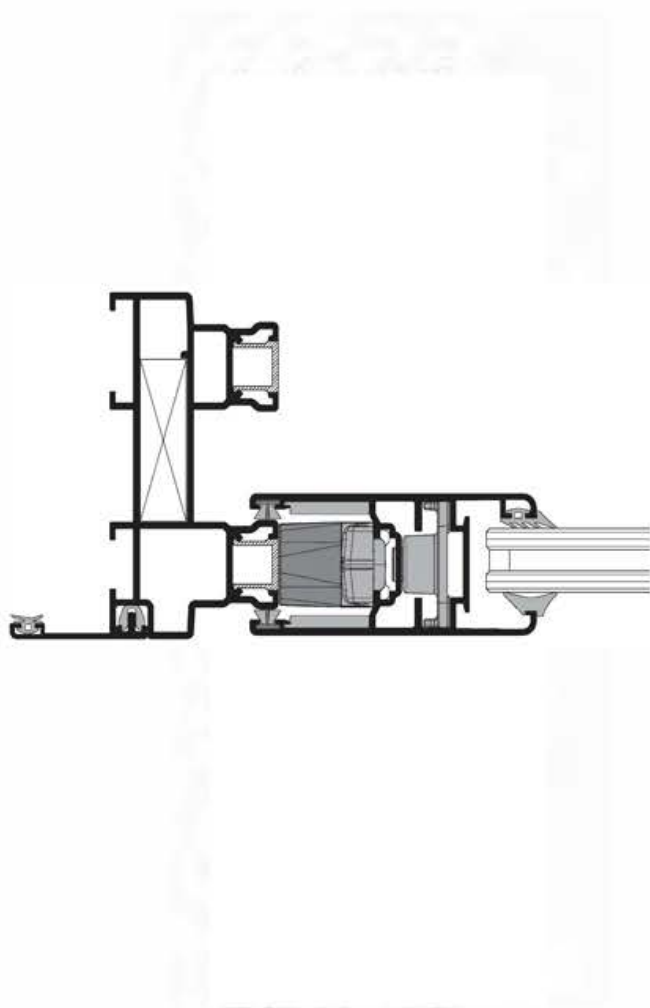

*Technical Charactarestic

Frame	Depth	98mm -to- 124mm
	Height	52mm
Sash	Depth	40mm
	Height	86mm
Max glass thickness	Up to 24mm	
Max sash weight	Up to 200kg	
Sealing type	Perimetrical, with two rows of high-density brushes or EPDM gaskets for tilt and slide.	

*Complies with the European norm hEN 14351-1

Air permability	(Class 3) up to 600 pa
Water tightness	(Class 6A) up to 250 pa
Resistance to wind load	(Class B3) up to 1200 pa



Louvers

A complete system for solar control by adapting the slat length and its angle. Wide range of slats in shape and dimensions, easy to install with different angles and intervals. Can be mount vertically, horizontally and inclined.

Integrated with our other systems.

Mullion: 42 mm, Slat: (150 - 120 - 100 - 80 - 60) mm

- **ACACIA 42**
- **ACACIA 50**

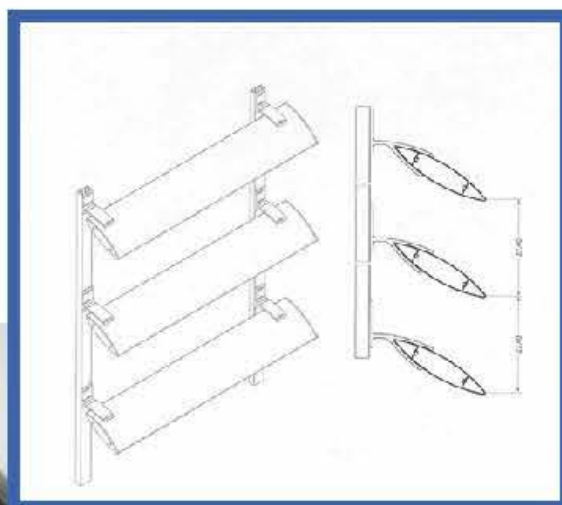

SH 45

The SH45- is a non-insulated hinged system that has been designed to respond to new aesthetical demands of frame 47/45 mm and vent 47mm. The system is available in functional and soft line design. The profile width is reduced to a minimum allowing a maximum of light into the building. SH-45 integrates the latest techniques, offering a very competitive solution.

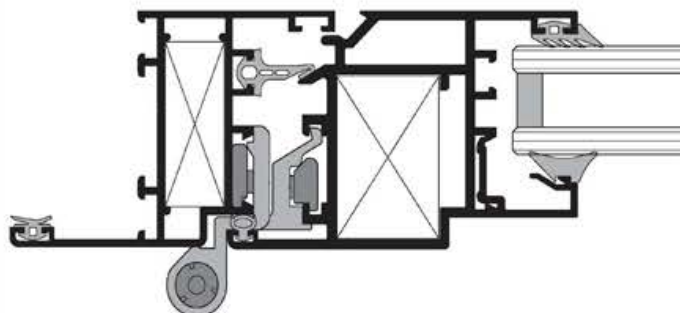

*Technical Characteristic

Frame	Depth	45mm -to- 57mm
	Height	46mm -to- 116mm
Sash	Depth	45mm -to- 52mm
	Height	64mm -to- 100mm
Max glass thickness	Up to 44mm	
Max sash weight	Up to 110kg	
Sealing type	EPDM gasket with Central gasket	

*Complies with the European norm hEN 14351-1

Air permability	(Class 4) up to 600 pa
Water tightness	(Class E900) up to 900 pa
Resistance to wind load	(Class C4) up to 1600 pa





CURTAIN WALL CW52

CW 52 is a curtain wall façade and roof system that offers unlimited creative freedom and allows maximum entrance of light into the building. The system offers 11 individual styles with various outside appearances one or two way structural. Any combination of vertical and inclined planes are possible together with the integration of different types of vents.

The extensive range offers technical solution for the different performance requirements of a façade such as high insulation solutions, thus not limiting but on the contrary stimulating architectural creativity.

Performance	
Item	Specification
Wind pressure resistance	$\geq 5.0\text{kpa}$
Air Infiltration	$\leq 0.5\text{m}^3/(\text{h.m})$
Water Penetration	$\geq 700\text{kpa}$
Heat Preservation (K factor)	$\leq 2.0\text{W}/(\text{m.K})$

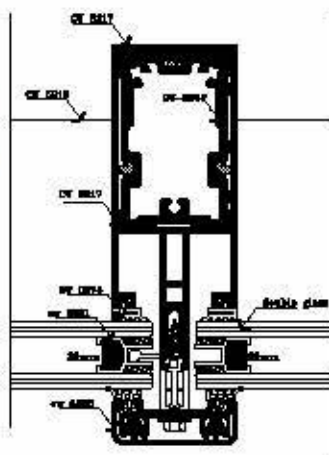

STRUCTURE GLAZING & SKY LIGHTS CW-62

CW 62 is an excellent thermally improved curtain wall system for large glass surface (cassettes can hold a weight up to 200 kg per glass panel), sloping and vertical or curved constructions, especially for renovation projects.

The glazing is secured by clamp guides on the supporting construction and is held gripped under a rebate height of 25 mm. CW 62 is made up of an extensive profile range and facilitates the integration of all types of vent systems. The updated CW 62 offers four individual styles which each allow for the application is available.

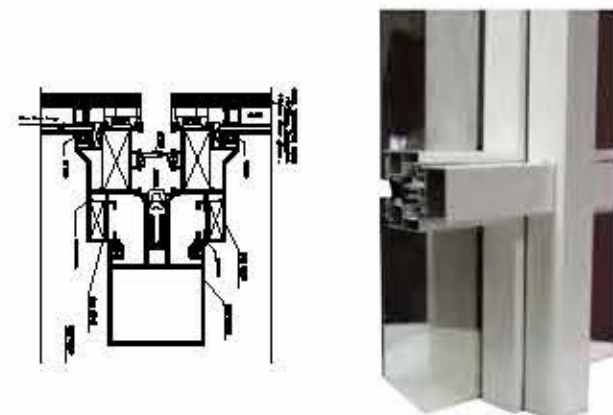

Performance	
Item	Specification
Wind pressure resistance	$\geq 5.0\text{kpa}$
Air Infiltration	$\leq 0.5\text{m}^3/(\text{h.m})$
Water Penetration	$\geq 700\text{kpa}$
Heat Preservation (K factor)	$\leq 2.0\text{W}/(\text{m.K})$









CW 65 THERMAL UNITIZED

CW 65-Element Facade from Reynaers enables unitized facades to be completely pre-assembled in the workshop.

This results in a high execution speed on the site.

Productivity here however embraces architectural aesthetic requirements as the CW 65-EF works with slender profiles of only 65 mm. The slender profile is very strong and can be used for maximum widths of 1600 mm and heights up to 3700 mm. The facade system is thus very well suited for high-rise constructions.

PERFORMANCES				
		CW-65 EF	CW-65 EF-HI	CW-65 EF-SG
	Air tightness	Class A4	Class A4	Class AE 700
	Thermal insulation	down to 2,54 W/m ² K, depending on the profile combination	down to 1,51 W/m ² K, depending on the profile combination	down to 7,6 W/m ² K, depending on the profile combination and glass composition
	Water tightness	Class RE 1200	Class RE 1200	Class RE 1200
	Wind load resistance	1800 Pa	1800 Pa	1400 Pa

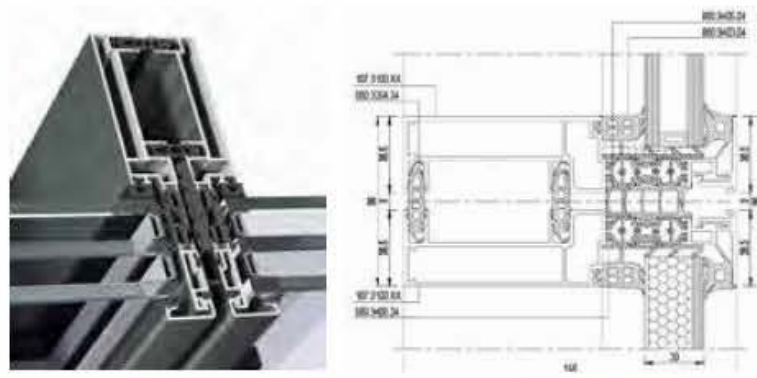

CS ECO THERMAL BREAK

Eco system is a high performance aluminum hinged system from Reynaers that combines aesthetic design with energy efficiency. With an Uf-value down to 2.20 W/m²K, this system meets the latest thermal insulation requirements.

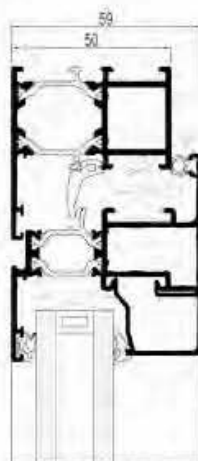

PERFORMANCES

	Acoustic performance	Rw (C, Ctr) = 35 (-1;-4) dB / 39 (-1;-3) dB, depending on the glazing type
	Air tightness	Up to 600 Pa (class 4)
	Anti-burglar	WK 2 (windows & doors) (European standard ENV 1627 - ENV 1630)
	Thermal Insulation	Uf-value between 2.2 W/m ² K and 2.6 W/m ² K, depending on the frame/vent combination
	Water tightness	Up to 750 Pa (class E750)
	Wind load resistance	Up to 1600 Pa (class 4)

CP 96 THERMAL BREAK

The CP 96 sliding and lift & slide elements from Reynaers are the perfect answer to the increasing demand for safety and durability at a fair price. They are combined with strong technical performances to make up a highly innovative system. The CP-96AP variant is also available in slide and lift & slide version and offers an enhanced burglary resistance.

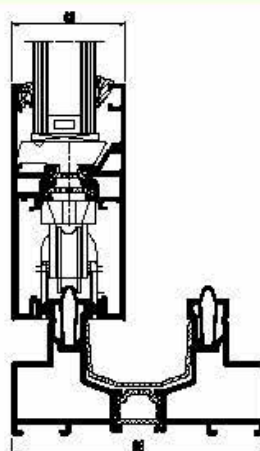

PERFORMANCES

	Air tightness	Up to 600 Pa (class 4)
	Anti-burglar	WK 2 (Dutch standard NEN 5096)
	Thermal Insulation	Uf-value between 3.5 W/m ² K and 6.3 W/m ² K, depending on the frame/vent combination
	Water tightness	Up to 600 Pa (class 9A)
	Wind load resistance	Up to 1200 Pa (class 3)

ALUMINUM CLADDING

Our technical office supports designs & details for projects & big constructions using the latest design programs to print out full dimensions for the structural glassing & curtain walls & sky lights in plan elevations, segmental and curved or rounded which fulfill installation success. And study all relations which are related to our job with high technical & experience labor for installation.

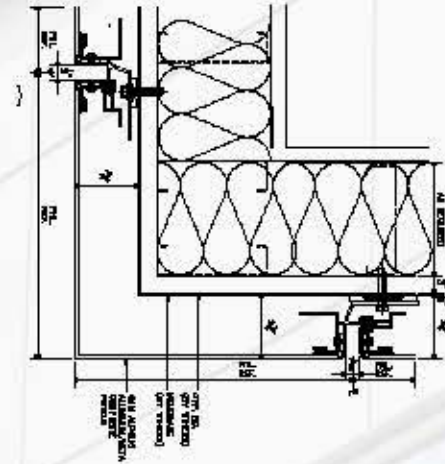





SERVICES

Our Service Department handles all types of customer service needs, such as replacement of hardware or broken glass.

Our service department will handle it all, including replacement of new construction jobs. We can perform any maintenance under the sun (or under your roof!) on windows and doors

Do you need a part that is dated up to 10 years ago? Contact the Head office or Factory location and ask for the Service Department to find more information.

Our service is as strong as your expectation should be for windows and doors



MARKETING

Our Service Department handles all types of customer service needs, such as replacement hardware or broken glass .

Our service department will handle it all, including replacement of new construction jobs. We can perform any maintenance under the sun (or under your roof!) on windows and doors

Need a part that is dated up to 10 years ago? Contact the Head office or Factory location and ask for the Service Department to find more information.

Our service is as strong as your expectation should be for windows and doors

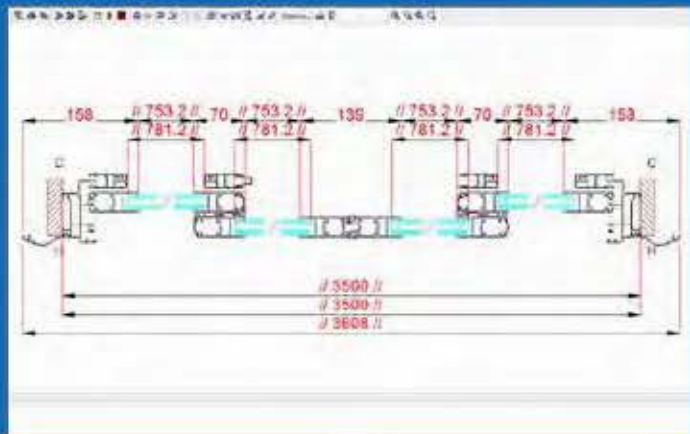

SAFETY

The intention is to insure that all health and safety issues are considered and managed from inception through to completion of the project and to consider future implications for health and safety during the life of the structure.

To assist the co-ordination of all aspects of health and safety from inception and beyond. To appoint competent person to the project (including designers, planning, supervision, principal contractor and contractors) To prepare a health and safety plan for construction and a health and safety file for the completed structure. To ensure adequate allocations of resource in order that the suites imposed by the regulations can be met. To assist those associated with the project in achieving a safe working environment both for the original construction phases and future construction work.

Client's Responsibilities

To appoint a competent planning supervisor and a competent principal contractor.

Planning Supervisor Responsibilities

To ensure that details of the project are notified to the health and safety executive notification is only necessary if the construction work will take more than 30 working days or 500 person days.

Designers Responsibilities

To ensure that the duties under the regulations and any practical guidance issued by the health and safety executive and understood by the client.

Principal Contractor's Responsibilities

To ensure cooperation between contractors on site

Contractor's Responsibilities

To cooperate with the principal contractor.

The Health and Safety Plan

1. A general description of the construction work.
2. The timescale for the project and its stages.
3. Details of known or responsibly foreseeable risks.
4. Information on the competence and resources of those involved in the
5. project.
6. Information to allow the principal contractors and other contractors with
7. their duties.
8. Arrangements for the management and monitoring of risks.
9. Information about welfare arrangements.

The Health and Safety File

1. The construction methods and materials.
2. Information regarding the equipment and maintenance facilities within the
3. structure.
4. Maintenance procedures and requirements for the structure.
5. Manual outlining and maintenance procedures and schedules for the plant
6. and equipment installed as part of the structure.





SYSTEM GUARANTEE

Quali'metal System Guarantees that all Quali'metal Aluminum works meet the technical specifications and the country and the product in question. The current processing and maintenance regulations mentioned in the Quali'metal works catalogues determine the extent of this 10 years (5 years for wearing parts)

QUALI'METAL FABRICATOR GUARANTEE DECLARATION

Any defect for which a guarantee claim is being made must be notified to Quali'metal System in writing within one week of being identified, under penalty of dissolution of the right to appeal to the guarantee. Any form of compensation is excluded in case of the belated declaration to be admissible, the guarantee claim must be accompanied by a copy of Quali'metal System invoice and a copy of the order form, with information with information regarding the building site added.

EXTENT OF THE GUARANTEE

The following items are covered by the guarantee (As indicated on the order)

- Repairs on-site.
- Re-delivery of the faulty product
- Fabrication costs
- Removal and refitting costs.

FABRICATOR CERTIFICATE

Quali'metal system Guarantees that all Quali'metal Aluminum works meet the technical specifications and the country and the product in question.

The current processing and maintenance regulations mentioned (years for wearing parts 5) years 10 in the Quali'metal works catalogues determine the extent of this.





QUALI'METAL System
for Manufacturing, Trading & Contracting Aluminum

FABRICATOR CERTIFICATE



QualiMetal System Guarantees that all QualiMetal Aluminum works meet the technical specifications and the country and the product in question. The current processing and maintenance regulations mentioned (years for wearing parts 5) years 10 in the QualiMetalworks catalogues determine the extent of this

Fabricator Certificate From QualiMetal systems

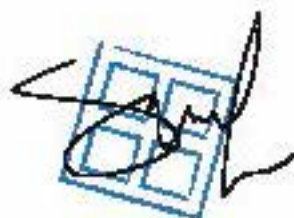

VALID 2015

QUALI'METAL System
for Manufacturing, Trading & Contracting Aluminum



VALID 2015

QUALI'METAL System
for Manufacturing, Trading & Contracting Aluminum



VALID 2015

QUALI'METAL System
for Manufacturing, Trading & Contracting Aluminum

71 Sakr Koresk - Sheraton - Heliopolis, Cairo - Egypt
Tel.: +202 22672442 - 22666792 Fax: +202 22672442 - 20 122159724
info@quali-metal.com



QUALI'METAL System
for Manufacturing, Trading & Contracting Aluminum

Industrial development & workers bank of Egypt (IDWB)







QUALI'METAL System
for Manufacturing, Trading & Contracting Aluminum







QUALI'METAL System
for Manufacturing, Trading & Contracting Aluminum

EL GALALA FOOD COURT







QUALI'METAL System
for Manufacturing, Trading & Contracting Aluminum

COPTIC HOSPITAL IN ZAMBIA



COPTIC HOSPITAL IN KENYA





QUALI'METAL System
for Manufacturing, Trading & Contracting Aluminum

ARMY CONFERENCE HALL



MILITARY TECHNICAL COLLEGE





QUALI`METAL System
for Manufacturing, Trading & Contracting Aluminum

CREDENTIALS

CIB BANK



EL WATANYA COMPANY





QUALI'METAL System
for Manufacturing, Trading & Contracting Aluminum

AL GALAA HOTEL



BOSCH - HEAD OFFICE





QUALI'METAL System
for Manufacturing, Trading & Contracting Aluminum

SCHOOL OF MICHANICAL



MERCEDES BENZ - CNA





QUALI'METAL System
for Manufacturing, Trading & Contracting Aluminum

MCV - ADMINISTRATIVE BUILDING



LE MERIDIEN PYRAMIDS HOTEL & SPA





QUALI'METAL System
for Manufacturing, Trading & Contracting Aluminum

GOLDEN COAST RESORT - SHARM EL SHEIKH



DAR AL WATHAEK - CAIRO GOVERNMENT





QUALI'METAL System
for Manufacturing, Trading & Contracting Aluminum

CAIRO UNIVERSITY



LUXOR



RESIDENTIAL





FACTORY

for fabrication in OBOUR Industrial Zone under the license of the CAIRO INVESTMENT COMMERCIAL REGISTRY. Currently employs staff qualified people with an administrative office. All the production and the assembly is equipped with PNEUMATIC.

It consists of two separate production lines for windows, doors and curtain walls systems with different fabrication facilities.

- Standard Windows and doors
- Non-standard Window and doors
- Curtain wall and structural glazing
- Skylights
- Cladding
- Auxiliary products
- Hardware Assembly







QUALI'METAL System
for Manufacturing, Trading & Contracting Aluminum

PARTNERS



MACHINES & ALUMINIUM CENTER

Founded in 1978. They are number one in Egypt designers for all profiles needed for real estate and all kinds of architectural opening that meet the consultants and the designers.

Their designs to profiles under the European code fulfill the exporting market with very professional design and quality controlled.



FAPA SISTEMI
Fabbrica Zanzariere

Type your partner's outside Egypt (in Italy) and a link for their website and you can type a small paragraph in 3 or 5 lines and you can get it from their website or a catalogue with you.

Fapa is an artisan manufacturing company specialized in roller blinds and bellow doors in PVC, Born in Rome in 1970, and since 1988 she is presenting in the mosquito-nets' market, covering in particular the Lazio Region.



FomIndustrie

has been well known for more than 30 years for quality systems for cutting and machining aluminum. Its products' high technology content and proven reliability has been the keystone of its success on the world's main markets.

We are agent for FOM INDUSTRIE who supplies our factory with their machines & we do maintenance as a first line support for any machines bought from them in Egypt.

<< Dr.Greiche >>

is a pioneer in producing safety Auto Glass (tempered and laminated) for a wide range of cars and buses according to the International specifications. We are a main supplier of auto-glass for O.E.M glass and replacement market.



continuously listens to the requirements and wishes of window fabricators and façade manufacturers. We aim to provide you with all the means to work as well and efficiently as possible. Reynaers is remarkable for its fire rating and high quality sound barrier profiles.



**Parteners
in quality**

Coating Aluminum profiles with all types of coating (Real, Antique, wood-like coating , rince & Recolor.



QUALI'SMETAL System
for Manufacturing, Trading & Contracting Aluminum

Head Office

71 Sakr Koresh, Abd El Hamid Badawi, Sheraton,
Heliopolis, Cairo – Egypt

Tel.: +202 22672442 - 22699307
Telefax: +202 22672442 - +20 1222330870
Emails: quali_metal@link.net

Information: info@quali-metal.com

Factory

3.172 street .block 20023 west extension industrial area
El-Obour city, Cairo- Egypt.

Tel.: +202 44893108
+202 44893357